

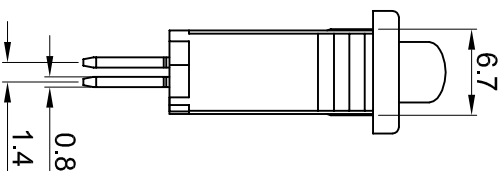

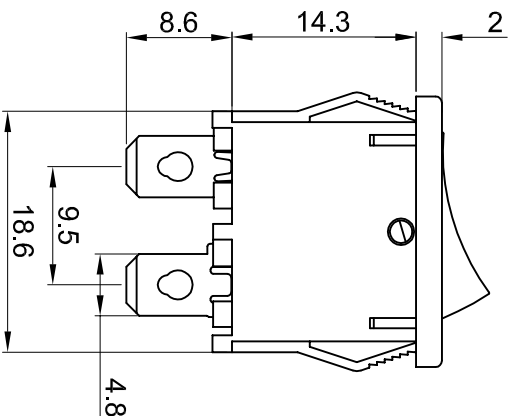

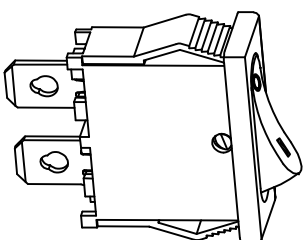
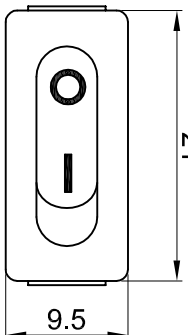

MR-2

21



Rating: 10A 125VAC ,6A 250VAC (UL CUL) 
 6A 250V AC (VDE CQC CB) 
 Contact Resistance: 50mΩ Max 
 Insulation Resistance: DC 500V 100MΩ Min
 Dielectric Strength: AC1500V 1 minute
 Operating Temperature: 0°C~85°C

受控文件

CUT-OUT

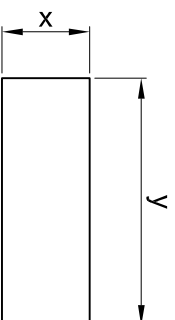

	X	Y
0.75~1.25	6.8-0.1	19.2±0.1
1.25~2.00	6.8-0.1	19.2±0.1
2.00~3.00	6.8-0.1	19.2±0.1

MATERIAL:

Body: Nylon66, UL rated:94V-2 min
 Actuator: Nylon66, UL rated:94V-2 min
 Terminal: Brass, silver or tin plated

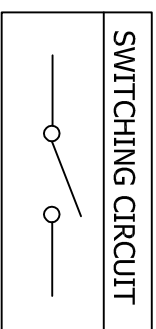

公差 TOLERANCES

.X± 0.3 .XX± 0.15

角度 ANGLE ± 1°

单位 DIMENSION UNIT mm.

版本 VER.	变更说明 CHANGE DESCRIPTION	日期 DATE	ECN NO.	批准 APPROVED BY	核对 CHECKED BY	绘图 DRAWN BY	品名 TITLE	图号 DRAWING NO
				李新超	李伟奇	黄雄阳	MR-2-110-C5N-BB	MR-2-110-C5N-BB_A1